

DLF-108

8" Square Housing For

(1) or (2) DTT/TTT Lamps.

Catalog #		Type
Project		Date
Prepared by		

FLUORESCENT

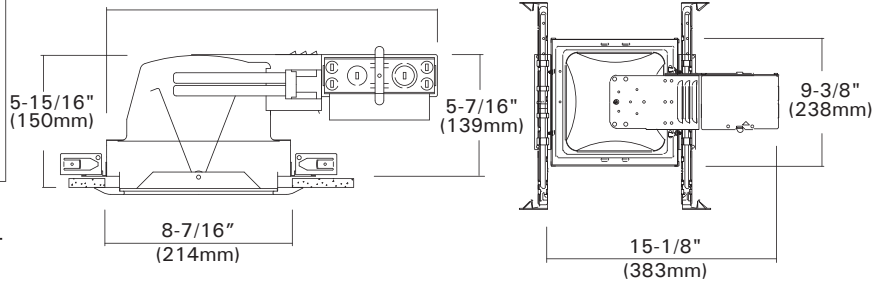

DESCRIPTION

The DLF-108 is a 8" aperture square housing for (1) or (2) horizontal CFL lamps. The DLF-108 is designed for use in non-insulated ceilings or for insulated ceilings, but insulation must be kept 3" away from all sides of the housing.

DESIGN FEATURES

Ceiling Cut-out : 8-7/16" x 8-7/16"
Lamp, Max. Watt. : (1)42W or (2)26W

• Housing

- Galvanized steel housing, white painted.
- 5-15/16" height allows to use in 2"X6" joist construction.
- Housing adjusts for ceilings up to 1-1/4" thick.

• Junction Box

- Listed for through branch circuit wiring.(Max.8 No 12 AWG 90°C branch circuit conductors. (4 in, 4 out)
- (5)1/2" knockouts with true pry-out slots and (4) knockouts with Romex cable clamp.
- Ground wire provided on J-box.

• Bar hangers

- Maximum extension by 24" allows excess distance between joists.
- Housing can be positioned at any point within 24" joist span.
- Score lines allow "toolless" shortening for 12" joists. Bar hangers may be repositioned 90 degrees.
- Integral T-bar clips snaps onto T-bars and no additional clips are required.

• Trim

- Steel white painted square trim with acrylic or glass lens.

• Socket

- G24Q/GX24Q socket for use 4pin DTT, TTT lamps.

• Lamp

- Compact Fluorescent lamps.
 - * DTT-Double twin tube (Quad/CFQ)
 - (1) or (2) 13W DTT (4 pin)
 - (1) or (2) 18W DTT (4 pin)
 - (1) or (2) 26W DTT (4 pin)
 - * TTT-Triple Twin Tube (CFTR)
 - (1) 18W TTT (4 pin)
 - (1) 26W TTT (4 pin)
 - (1) 32W TTT (4 pin)
 - (1) 42W TTT (4 pin)

• Electronic Ballast

- Class P Thermally protected by internal fuse (3 amp fast blow), Multi-volt electronic ballast thermal cut-out switch in magnetic ballast.
- High Power Factor Multi-volt Electronic ballasts for 4 pin type compact fluorescent lamps mounted on J-box door for easy access from inside of fixture.

* Listing

- UL, c-UL listed for damp location.
- UL, c-UL listed for feed through.

• Just-A-Nail

Adjustable nail hanger bar for easy alignment.

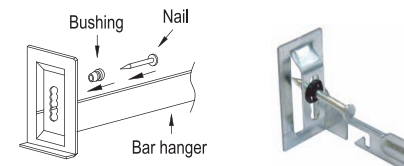

JUST-A-NAIL

- Pre-installed nail bars with vertical slots are used to evenly align the bars horizontally after nailing halfway into wood joists.

• Optional "Quick Connect" Push-in wire connectors.

- Three "Quick Connectors"
- Pre-installed push-in wire connectors for fast and easy wiring.

Trims



White Square Trim w/ Flat Frosted Lens
 Frame : 9-3/8" x 9-3/8"

TMS-12-WH

Ordering Information

Housing	Ballast	Lamp(s) Watt.	Option
DLF-108	-N : 120V NPF Magnetic -H : 120V HPF Magnetic -NE : 120V NPF Electronic -HE : 120V HPF Electronic -E : 120V/277V HPF Electronic	126 : (1)26W 213 : (2)13W 132 : (1)32W 218 : (2)18W 142 : (1)42W 226 : (2)26W	-EM : Emergency w/ Remote Test Switch -C : Quick Connectors

Example : DLF-108-E126